

REVISED: FEB 24, 1999

PLAT OF SURVEY PREPARED FOR: JOSEPH H. AND KAREN E. STAFFORD

DEED OF RECORD: VOLUME 609, PAGE 264 AND VOLUME 927, PAGE 707 (PARCEL NO. 1)

PLAT OF SURVEY PREPARED BY
DELMAR B. KOSIE & ASSOCIATES
 REGISTERED LAND SURVEYORS
 202 SOUTH STREET
 CHARDON, OHIO 44024
 (440) 286-2131

WOODIN ROAD 60'

1" IRON PIN IN
 MONUMENT BOX
 FD. AND USED

1" IRON PIN IN
 MONUMENT BOX
 FD. AND USED

J.J. GRUENER
 VOL. 927, PG. 707 & 708
 PARCEL NO. 2

1.520 ACRE PARCEL

DEED OF RECORD:
 VOLUME 609, PAGE 264
 J. & K. STAFFORD

GEAUGA COUNTY
 VOL. 159, PG. 37

*NOTE:
 THIS STABLE MUST BE MAINTAINED AS
 AGRICULTURAL USE ONLY. ANY DEVIATION
 MAY RESULT IN FINES, PENALTIES, AND OR
 FORCED DEMOLITION.

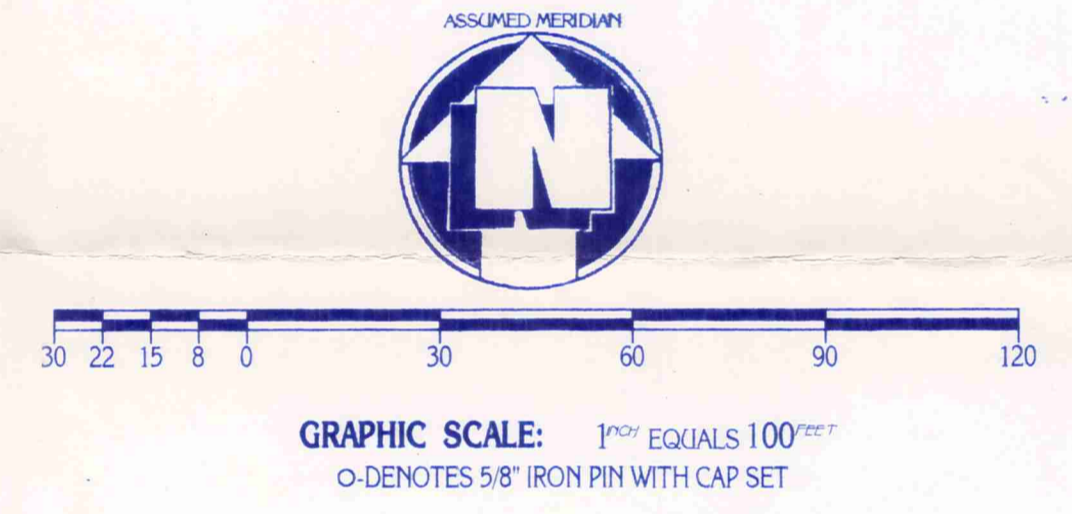

0.6' x 0.3' SQUARE
 STONE MONUMENT
 FD. AND USED

N 85°14'17" W 287.10' TOTAL rec.
 196.40' calc.

0.1589 ACRE PARCEL
 (6925.0485 SQUARE FEET)
 DEED OF RECORD:
 VOL. 927, PG. 707
 (PARCEL NO. 1)

J.J. GRUENER
 VOL. 927, PG. 707
 PARCEL NO. 1



SURVEY PLAT & LEGAL DESCRIPTION
 APPROVED PER R.C. 315.251
 R.S. 2 2599
 OFFICE OF THE
 GEAUGA COUNTY ENGINEER

MONUMENTS WERE FOUND OR SET AS INDICATED HEREON.
 DISTANCES ARE IN U.S. FEET WITH DECIMAL PARTS.
 BEARINGS ARE TO AN ASSUMED MERIDIAN AND INDICATE ANGLES ONLY.
 I HEREBY CERTIFY THAT I HAVE SURVEYED THESE PREMISES AND
 PREPARED THIS PLAT OF SURVEY IN ACCORDANCE WITH THE PROVISIONS
 OF CHAPTER 4733-37 OF THE OHIO REVISED CODE.

Delmar B. Kosie
 DELMAR B. KOSIE
 REGISTERED PROFESSIONAL SURVEYOR
 REGISTRATION NO. 5276



SITUATED IN THE TOWNSHIP OF CHARDON,
 COUNTY OF GEAUGA AND STATE OF OHIO,
 AND KNOWN AS BEING PART OF ORIGINAL
 LOT NO. 31, IN TRACT NO. 2, WITHIN
 SAID TOWNSHIP.

PLAT NO. 512 99

CHA00116
CHA00116

Stafford
picked up 2-26-99

DELMAR B. KOSIE & ASSOCIATES

REGISTERED LAND SURVEYORS



200 SOUTH STREET
CHARDON, OHIO 44024
(440) 286-2131

0.1589 ACRE PARCEL (6925.0485 SQUARE FEET)

DEED OF RECORD: VOLUME 927, PAGE 707 (PARCEL NO. 1)
REVISED: FEB 24, 1999

SITUATED IN THE TOWNSHIP OF CHARDON, COUNTY OF GEAUGA AND STATE OF OHIO AND KNOWN AS BEING PART OF ORIGINAL LOT NO. 31, IN TRACT NO. 2, WITHIN SAID TOWNSHIP AND BOUNDED AND DESCRIBED AS FOLLOWS:

BEGINNING AT A 1" IRON PIN IN A MONUMENT BOX FOUND AT AN ANGLE POINT ON THE CENTERLINE OF WOODIN ROAD (60 FEET WIDE).

THENCE S77 31'28"W ALONG SAID CENTERLINE A DISTANCE OF 63.07 FEET TO A POINT. SAID POINT BEING A NORTHWESTERLY CORNER OF A PARCEL OF LAND CONVEYED TO GEAUGA COUNTY AS RECORDED IN VOL. 159, PG. 37 OF GEAUGA COUNTY RECORDS AND DEEDS.

THENCE S04 29'58"W ALONG A WESTERLY LINE OF SAID GEAUGA COUNTIES LAND AND PASSING THROUGH A 5/8" IRON PIN SET AT 31.22 FEET A TOTAL DISTANCE OF 275.16 FEET TO A 5/8" IRON PIN SET. SAID POINT BEING A SOUTHWESTERLY CORNER OF SAID GEAUGA COUNTIES LAND.

THENCE S85 14'17"E ALONG A SOUTHERLY LINE OF SAID GEAUGA COUNTIES LAND A DISTANCE OF 9.30 FEET TO A 5/8" IRON PIN SET. SAID POINT BEING THE NORTHEASTERLY CORNER OF THE PARCEL HEREIN DESCRIBED. SAID POINT ALSO BEING THE PRINCIPAL PLACE OF BEGINNING OF THIS SURVEY.

THENCE S04 29'58"W A DISTANCE OF 69.25 FEET TO A 5/8" IRON PIN SET. SAID POINT BEING THE SOUTHEASTERLY CORNER OF THE PARCEL HEREIN DESCRIBED.

THENCE N85 14'17"W A DISTANCE OF 100.00 FEET TO A 5/8" IRON PIN SET. SAID POINT BEING THE SOUTHWESTERLY CORNER OF THE PARCEL HEREIN DESCRIBED.

THENCE N04 29'58"E A DISTANCE OF 69.25 FEET TO A 5/8" IRON PIN SET ON A SOUTHERLY LINE OF A PARCEL OF LAND CONVEYED TO J.H. AND K.E. STAFFORD AS RECORDED IN VOL. 609, PG. 264 OF GEAUGA COUNTY RECORDS AND DEEDS. SAID POINT ALSO BEING THE NORTHWESTERLY CORNER OF THE PARCEL HEREIN DESCRIBED.

THENCE S85 14'17"E ALONG SAID STAFFORDS SOUTHERLY LINE AND ALSO ALONG THE SOUTHERLY LINE OF THE AFORESAID GEAUGA COUNTY PARCEL A DISTANCE OF 100.00 FEET TO THE PRINCIPAL PLACE OF BEGINNING OF THIS SURVEY AND CONTAINING 0.1589 ACRES OF LAND (6925.0485 SQUARE FEET) AS SURVEYED BY DELMAR B. KOSIE AND ASSOCIATES (DELMAR B. KOSIE, REGISTERED SURVEYOR NO. 5276). FEBRUARY, 1999. BEARINGS ARE TO AN ASSUMED MERIDIAN AND INDICATE ANGLES ONLY.

SURVEY PLAT & LEGAL DESCRIPTION
APPROVED PER R.C. 315.251

R.S. 2/25/99
OFFICE OF THE Revised
GEAUGA COUNTY ENGINEER